

# DUMPS ARENA

**CompTIA A+ Certification Exam: Core 1**

**CompTIA 220-1201**

**Version Demo**

**Total Demo Questions: 15**

**Total Premium Questions: 240**

**Buy Premium PDF**

**<https://dumpsarena.co>**

**[sales@dumpsarena.co](mailto:sales@dumpsarena.co)**

**sales@dumpsarena.co**  
**dumpsarena.co**

**QUESTION NO: 1**

A technician needs to fix a Cat 5 cable issue. The cable, which is connected to a network jack, fails when it is moved around. Which of the following items must the technician use to fix the issue? (Select TWO).

- A. Scissors
- B. Network tap
- C. Magnetized screwdriver
- D. Tone generator
- E. RJ45 connector
- F. Crimper

**ANSWER: E F****Explanation:**

To fix a Cat 5 cable issue where the cable fails when it is moved around, the technician would need to use an RJ45 connector (option E) and a crimper (option F). The technician can use the crimper to attach a new RJ45 connector to the end of the cable, which should resolve the issue.

An RJ45 connector (option E) is a type of connector commonly used for Ethernet networking. It is an 8-position, 8-contact (8P8C) modular plug and jack that is used to terminate Cat 5 and other types of twisted pair cables. A crimper (option F) is a tool used to attach connectors to the ends of cables. In this case, the technician would use the crimper to attach a new RJ45 connector to the end of the Cat 5 cable.

When a cable fails when it is moved around, it often indicates that there is a problem with the connector at the end of the cable. By attaching a new RJ45 connector using a crimper, the technician can ensure that the cable has a secure and reliable connection.

**QUESTION NO: 2**

A user reboots a machine. On rebooting, the user hears one beep, and then an error message is displayed. Which of the following are MOST likely causing this issue? (Select TWO).

- A. RAM module
- B. Graphics card
- C. CPU
- D. Boot order
- E. USB flash drive
- F. Power supply

**ANSWER: A D**

**QUESTION NO: 3**

Which of the following are default ports for HTTP and HTTPS traffic? (Select TWO).

- A. 23
- B. 25
- C. 80
- D. 143
- E. 389
- F. 443

**ANSWER: C F**

**QUESTION NO: 4**

A user reports a cell phone is getting hot. Which of the following are MOST likely to be possible causes? (Select THREE).

- A. Using the device as a Wi-Fi hotspot
- B. A cracked screen
- C. A failing battery
- D. Less than 15% free storage space on the phone
- E. Privileged control
- F. Recurring prompts to install OS updates
- G. Granting too many application camera permissions
- H. Too many open applications

**ANSWER: A C H**

**QUESTION NO: 5**

The owner of a restaurant reports that wireless network connections are lost intermittently throughout the day. Which of the following steps should a technician take to troubleshoot the issue? (Select TWO).

- A. Identify the location of devices that utilize 2.4GHz.
- B. Check to see if the phones are IJTP or STP lines.

- C. Test to see if the copper electrical Wires are causing interference.
- D. Map all of the wireless signals in the restaurant.
- E. Verify T568B is being used in the wiring closet patch panel.
- F. Schedule timed router reboots throughout the day.

**ANSWER: A D**

**Explanation:**

The correct answers are A. Identify the location of devices that utilize 2.4GHz and D. Map all of the wireless signals in the restaurant. In order to troubleshoot the issue, the technician should first identify the location of devices that utilize the 2.4GHz frequency, as this can cause interference with the wireless signal. Additionally, the technician should map all of the wireless signals in the restaurant in order to identify any potential sources of interference. Checking to see if the phones are IJTP or STP lines, testing to see if the copper electrical wires are causing interference, verifying T568B is being used in the wiring closet patch panel, and scheduling timed router reboots throughout the day are not necessary steps for troubleshooting this issue.

**QUESTION NO: 6 - (SIMULATION)**

Laura, a customer, has instructed you to configure her home office wireless access point.

She plans to use the wireless network for finances and has requested that the network be setup with the highest encryption possible.

Additionally, Laura knows that her neighbors have wireless networks and wants to ensure that her network is not being interfered with by the other networks.

She requests that the default settings be changed to the following.

Wireless Name: HomeWiFi

Shared Key: CompTIA

Router Password: Secure\$1

Finally, Laura wants to ensure that only her laptop and Smartphone can connect to the network.

Laptop: IP Address 192.168.1.100

Hardware Address: 00:0A:BF:03:C4:54

Smartphone: IP Address 192.168.1.101

Hardware Address: 09:2C:D0:22:3F:11

**INSTRUCTIONS**

Configure Laura's wireless network using the network adapter window.

If at any time you would like to bring back the initial state of the situation, please click the Reset All button.

### Laura's Wireless Configuration

**WIRELESS SETUP**    **NETWORK FILTER**    **ADMINISTRATOR TOOLS**

#### Wireless Network Settings

Enable Wireless:

Wireless Network Name:  (Also called the SSID)

Wireless Channel:

Disable SSID Broadcast:

802.11g Only Mode:

#### Wireless Security Mode

Security Mode:

#### WPA2

Passphrase:

Confirmed Passphrase:

### Laura's House

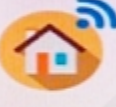
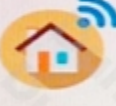
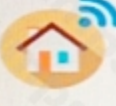

	Wireless Network Name: <b>Default</b>
	Security Mode: <b>Open</b>
	Wireless Channel: <b>11</b>
	Wireless Network Name: <b>MyWi</b>
	Security Mode: <b>WEP</b>
	Wireless Channel: <b>6</b>
	Wireless Network Name: <b>PatsWiFi</b>
	Security Mode: <b>WEP</b>
	Wireless Channel: <b>11</b>

### Laura's Wireless Configuration

**WIRELESS SETUP**    **NETWORK FILTER**    **ADMINISTRATOR TOOLS**

Please enter the same password into both boxes for confirmation.

Password:

Verify Password:

### Laura's Wireless Configuration

**WIRELESS SETUP**    **NETWORK FILTER**    **ADMINISTRATOR TOOLS**

**Wireless Network Settings**

Enable Wireless:

Wireless Network Name:  (Also called the SSID)

Wireless Channel:

Disable SSID Broadcast:

802.11g Only Mode:

**Wireless Security Mode**

Security Mode:

### Laura's Wireless Configuration

**WIRELESS SETUP**    **NETWORK FILTER**    **ADMINISTRATOR TOOLS**

Turn MAC Filtering ON:

**ANSWER: Seetheexplanationbelow**

Explanation:

solution as

The image shows a 'Wireless Configuration' window with three tabs: 'Wireless Setup', 'Network Filter', and 'Administrator Tools'. The 'Wireless Setup' tab is active, displaying 'WIRELESS NETWORK SETTINGS:' with the following options: 'Enable Wireless' (checked), 'Wireless Network Name' (HomeWiFi), 'Wireless Channel' (1), 'Disable SSID Broadcast' (unchecked), and '802.11g Only Mode' (unchecked). Below this is the 'WIRELESS SECURITY MODE:' section with 'Security Mode' set to 'Enable WPA2 Wireless Security (enhanced)'. The 'WPA2:' section includes 'Passphrase' and 'Confirmed Passphrase' both set to 'CompTIA'. A 'Save Settings' button is located at the bottom right.

### Wireless Configuration

Wireless Setup | **Network Filter** | Administrator Tools

Turn MAC Filtering ON

Allow the following MAC Addresses

MAC Address	
<input checked="" type="checkbox"/>	00:0A:BF:03:C4:54
<input checked="" type="checkbox"/>	09:2C:D0:22:3F:11
<input type="checkbox"/>	
<input type="checkbox"/>	

Save Settings



The image shows a screenshot of a web-based configuration interface titled "Wireless Configuration". At the top, there are three tabs: "Wireless Setup", "Network Filter", and "Administrator Tools". The "Administrator Tools" tab is selected. Below the tabs, there is a yellow header bar with the text "ADMIN PASSWORD". The main content area contains the instruction: "Please enter the same password into both boxes for confirmation." Below this instruction are two text input fields. The first field is labeled "Password:" and contains the text "Secure\$1". The second field is labeled "Verify Password:" and also contains the text "Secure\$1". At the bottom right of the form, there is a yellow button labeled "Save Settings". The background of the form has a repeating watermark that reads "DumpsArena".

**QUESTION NO: 7**

A field technician has been dispatched to a site with an internet outage. Upon arriving, the technician discovers that the POTS lines are not working as well. Which of the following technologies is the site MOST likely using?

A. Fiber

- B. Cable
- C. DSL
- D. Satellite

**ANSWER: C**

#### QUESTION NO: 8

A user who works with sensitive data has a computer configured with hard drive encryption. The TPM is active and hosting the encrypted key. After an upgrade to the motherboard, RAM and video card, the hard drive is not booting and data cannot be accessed from the hard drive. Which of the following should the technician do to enable the system to boot again and get access to the stored data?

- A. Use data recovery software to find and recover the hard drive information
- B. Access the BIOS and select to rebuild the degraded RAID array
- C. Boot into the BIOS and enable the TPM on the new motherboard.
- D. Return the replaced motherboard back to the computer

**ANSWER: C**

#### Explanation:

[The technician should boot into the BIOS and enable the TPM on the new motherboard to enable the system to boot again and get access to the stored data1.](#)

#### QUESTION NO: 9 - (HOTSPOT)

A customer built a computer for gaming, sourcing individual components and then assembling the system. The OS starts up, but within a few minutes the machine locks up. The customer brought the computer to a technician to diagnose the issue.

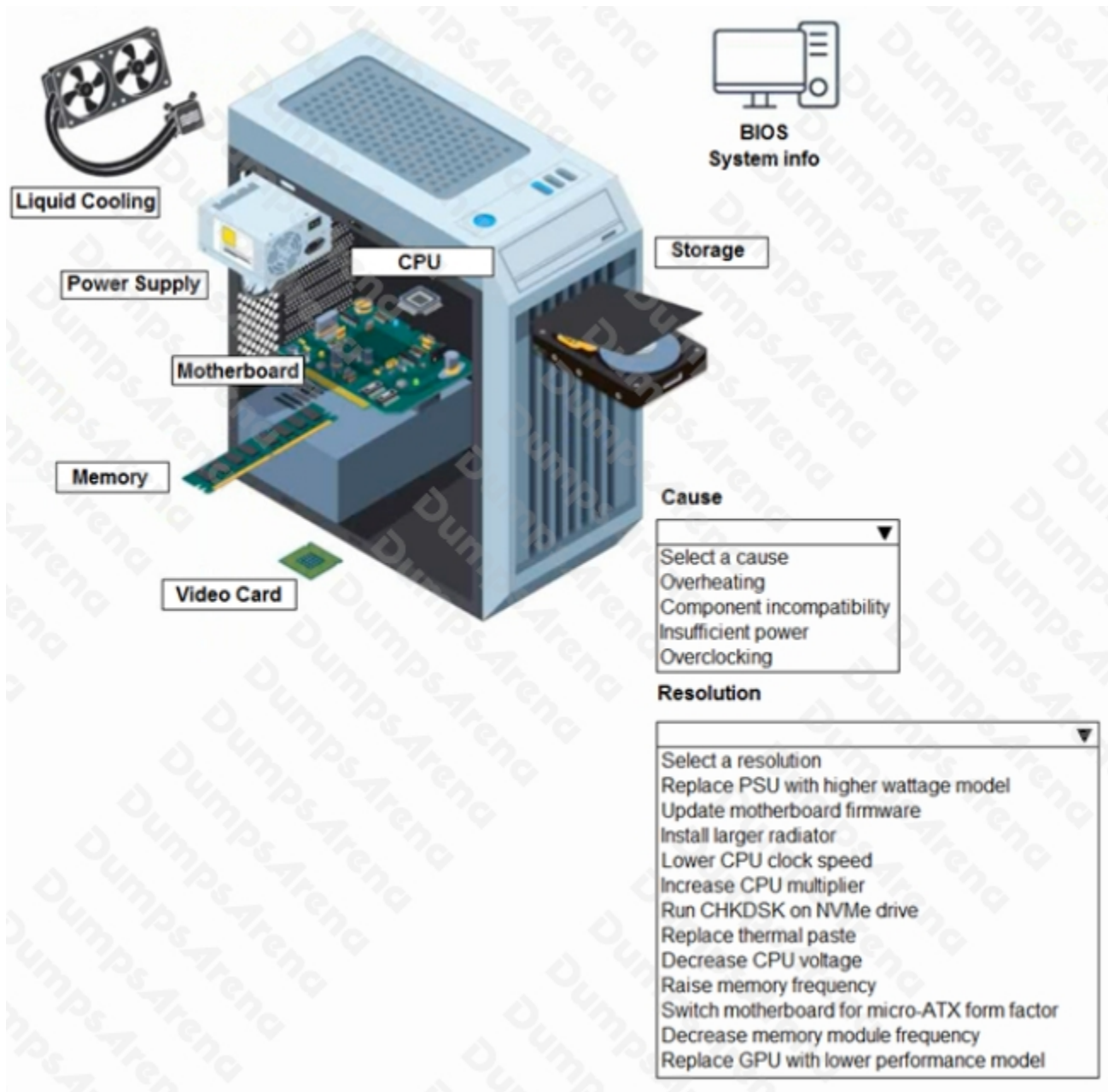

ANSWER:

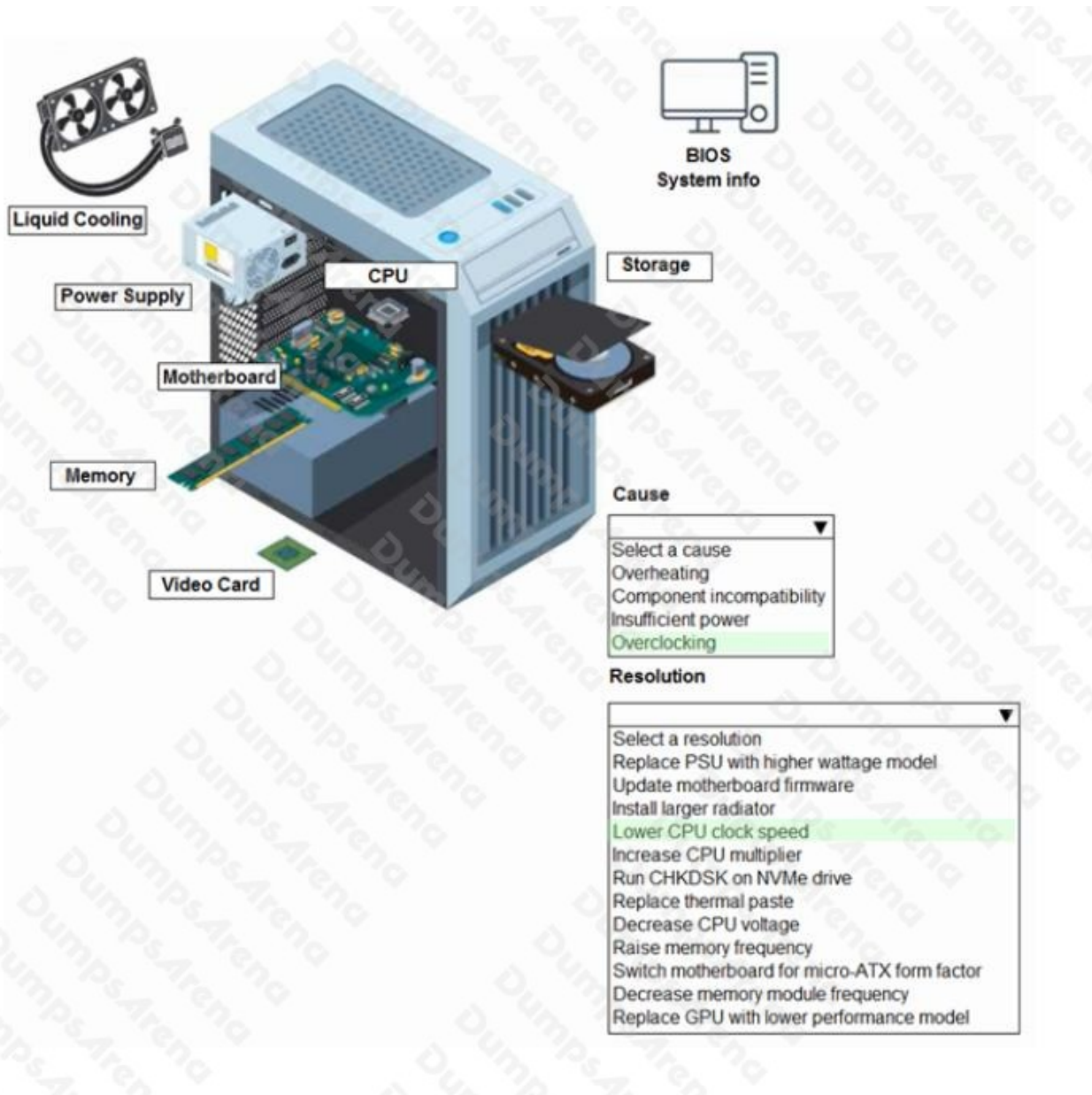

**Explanation:**

correct answer is "Overclocking" and "Reduce CPU Clock speed" CPU is at 4.5 Ghz when normal is 3.2 Ghz. Overclocking too much can cause freezes, and this is a gaming computer so the user probably took it too far.  
<http://blog.logicalincrements.com/2018/12/4-troubleshooting-tips-overclocking-pc/>

**QUESTION NO: 10**

Which of the following options provides correct information about 2.4GHz and 5GHz wireless frequencies? (Select TWO)

- A. 2.4GHz has less interference. 5GHz transmits in lower speed.
- B. 2.4GHz penetrates solid objects more effectively. 5GHz provides faster data connections.

- C. 2.4GHz has a higher data rate. 5GHz has 23 channels.
- D. 2.4GHz has 11 channels. 5GHz has no data interference.
- E. 2.4GHz has a higher coverage area. 5GHz has higher bandwidth.
- F. 2.4GHz has a higher bandwidth. 5GHz has lower transmit power.

**ANSWER: B E**

**Explanation:**

The correct answers are B. 2.4GHz penetrates solid objects more effectively. 5GHz provides faster data connections and E. 2.4GHz has a higher coverage area. 5GHz has higher bandwidth. The 2.4GHz frequency has a lower data rate compared to 5GHz, but it can penetrate solid objects more effectively and has a higher coverage area. The 5GHz frequency, on the other hand, provides faster data connections and has higher bandwidth, but it has fewer channels and lower transmit power.

**QUESTION NO: 11**

A startup company is outgrowing its current office space and is requiring employees to work remotely. The company must comply with government-enforced requirements to safeguard all aspects of data, so the IT department plans to maintain complete control over users' operating systems. Which of the following should the IT department implement?

- A. VDI
- B. IaaS
- C. VPN
- D. SaaS

**ANSWER: A**

**Explanation:**

The IT department should implement VDI. Virtual Desktop Infrastructure (VDI) is a technology that allows users to access a desktop operating system from a remote location. VDI provides complete control over users' operating systems, which is important for safeguarding data. [VDI also provides a secure way to access data from remote locations, which is important for compliance with government-enforced requirements1.](#)

**QUESTION NO: 12**

A user in a medical office contacts a technician regarding a printer that is used to print A4-sized labels. After the labels are printed, they mistakenly contain white space in the middle of the page. Which of the following would MOST likely be the cause?

- A. Contaminated fuser
- B. Worn rollers
- C. A misfeed

**D. Page orientation****ANSWER: D****Explanation:**

The most likely cause of the issue is that the page orientation is incorrect. [The printer may be set to print labels in a different orientation than the orientation of the label sheet1.](#)

**QUESTION NO: 13**

Which of the following describes the operational difference between hubs and switches when transmitting data to a specific computer inside the network?

- A. Switches only send data to the specific computer, while hubs send data to all computers inside the network.
- B. Switches compress data while hubs send uncompressed data
- C. Switches receive data and route it to all computers inside the network while hubs receive data and do not route
- D. Switches scramble data, while hubs send data in the original form.

**ANSWER: A****QUESTION NO: 14**

A university student was able to boot from a live Linux CD on a computer in a shared space on campus. Which of the following will BEST prevent this type of action from occurring in the future?

- A. Require TPM security features.
- B. Set a boot password.
- C. Disable all media options.
- D. Enable secure boot.

**ANSWER: D****Explanation:**

Enabling secure boot will verify the digital signature of the bootloader and operating system, ensuring that the system only boots from trusted and authorised sources. This can prevent booting from an unauthorised live CD or other external media.

The best way to prevent booting from a live Linux CD on a computer in a shared space on campus is to enable secure boot. Secure boot is a feature that ensures that the system only runs software that is signed by an authorized party. This means that the system will not boot from any unauthorized media, including live Linux CDs.

Secure Boot is a feature that ensures that the system only runs software that is signed by an authorized party. This means that the system will not boot from any unauthorized media, including live Linux CDs. [Secure Boot is an important security feature designed to prevent malicious software from loading when your PC starts up \(boots\)1.](#)

Booting from a live Linux CD is a process that allows you to run a Linux operating system from a CD or DVD without installing it on your hard drive. This can be useful for testing or troubleshooting purposes. To boot from a live Linux CD, you need to insert the CD or DVD into your computer's CD/DVD drive and restart your computer. [Most systems are set up to automatically boot from the CD/DVD drive, but if your system is not set up this way, you may need to change a system setting to boot from a Linux CD/DVD23.](#)

## QUESTION NO: 15

Which of the following types of devices MOST often uses a Thunderbolt cable?

- A. Linux PC
- B. Android mobile
- C. Apple laptop
- D. Chromebook

**ANSWER: C**