

DUMPS ARENA

CompTIA A+ Certification Exam: Core 1

CompTIA 220-1101

Version Demo

Total Demo Questions: 15

Total Premium Questions: 240

Buy Premium PDF

<https://dumpsarena.co>

sales@dumpsarena.co

sales@dumpsarena.co
dumpsarena.co

QUESTION NO: 1

A technician is commissioning a workstation that is required to have mirrored storage, utilizing two 4TB drives that support one failure. Which of the following BEST meets these requirements?

- A. RAID 0
- B. RAID 1
- C. RAID 5
- D. RAID 10

ANSWER: B

QUESTION NO: 2 - (SIMULATION)

Laura, a customer, has instructed you to configure her home office wireless access point.

She plans to use the wireless network for finances and has requested that the network be setup with the highest encryption possible.

Additionally, Laura knows that her neighbors have wireless networks and wants to ensure that her network is not being interfered with by the other networks.

She requests that the default settings be changed to the following.

Wireless Name: HomeWiFi

Shared Key: CompTIA

Router Password: Secure\$1

Finally, Laura wants to ensure that only her laptop and Smartphone can connect to the network.

Laptop: IP Address 192.168.1.100

Hardware Address: 00:0A:BF:03:C4:54

Smartphone: IP Address 192.168.1.101

Hardware Address: 09:2C:D0:22:3F:11

INSTRUCTIONS

Configure Laura's wireless network using the network adapter window.

If at any time you would like to bring back the initial state of the situation, please click the Reset All button.

Laura's Wireless Configuration

WIRELESS SETUP **NETWORK FILTER** **ADMINISTRATOR TOOLS**

Wireless Network Settings

Enable Wireless:

Wireless Network Name: (Also called the SSID)

Wireless Channel:

Disable SSID Broadcast:

802.11g Only Mode:

Wireless Security Mode

Security Mode:

WPA2

Passphrase:

Confirmed Passphrase:

Laura's House

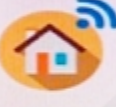
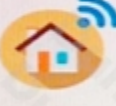
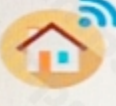

1

	Wireless Network Name: Default
	Security Mode: Open
	Wireless Channel: 11
	Wireless Network Name: MyWi
	Security Mode: WEP
	Wireless Channel: 6
	Wireless Network Name: PatsWiFi
	Security Mode: WEP
	Wireless Channel: 11

Laura's Wireless Configuration

WIRELESS SETUP **NETWORK FILTER** **ADMINISTRATOR TOOLS**

Please enter the same password into both boxes for confirmation.

Password:

Verify Password:

Laura's Wireless Configuration

WIRELESS SETUP **NETWORK FILTER** **ADMINISTRATOR TOOLS**

Wireless Network Settings

Enable Wireless:

Wireless Network Name: (Also called the SSID)

Wireless Channel:

Disable SSID Broadcast:

802.11g Only Mode:

Wireless Security Mode

Security Mode:

Laura's Wireless Configuration

WIRELESS SETUP **NETWORK FILTER** **ADMINISTRATOR TOOLS**

Turn MAC Filtering ON:

ANSWER: Seetheexplanationbelow

Explanation:

solution as

The screenshot shows a 'Wireless Configuration' window with three tabs: 'Wireless Setup', 'Network Filter', and 'Administrator Tools'. The 'Wireless Setup' tab is active, displaying 'WIRELESS NETWORK SETTINGS:' with the following options: 'Enable Wireless' (checked), 'Wireless Network Name' (HomeWiFi), 'Wireless Channel' (1), 'Disable SSID Broadcast' (unchecked), and '802.11g Only Mode' (unchecked). Below this is the 'WIRELESS SECURITY MODE:' section with 'Security Mode' set to 'Enable WPA2 Wireless Security (enhanced)'. The 'WPA2:' section includes 'Passphrase' and 'Confirmed Passphrase' both set to 'CompTIA'. A 'Save Settings' button is located at the bottom right.

Wireless Configuration

Wireless Setup | **Network Filter** | Administrator Tools

Turn MAC Filtering ON

Allow the following MAC Addresses

MAC Address	
<input checked="" type="checkbox"/>	00:0A:BF:03:C4:54
<input checked="" type="checkbox"/>	09:2C:D0:22:3F:11
<input type="checkbox"/>	
<input type="checkbox"/>	

Save Settings

The screenshot shows a web interface titled "Wireless Configuration" with a sub-tab "Administrator Tools". The main heading is "ADMIN PASSWORD". Below this, a message reads: "Please enter the same password into both boxes for confirmation." There are two input fields: "Password:" and "Verify Password:", both containing the text "Secure\$1". A "Save Settings" button is located at the bottom right of the form area.

QUESTION NO: 3

A user requested upgrades to a company-issued laptop to increase its performance while working with a large database stored on drive C. Which of the following tasks should a systems administrator complete to BEST meet this goal? (Select TWO).

- A. Configure RAID 1.
- B. Install a hybrid drive.
- C. Upgrade to 1GB NIC.
- D. Increase the RAM.
- E. Migrate to a SSD.
- F. Upgrade the power supply.

ANSWER: D E

Explanation:

To increase the performance of a laptop working with a large database stored on drive C, a systems administrator should increase the RAM and migrate to an SSD. Increasing the RAM will help the laptop to better handle the large database, while migrating to an SSD will improve the speed at which the laptop can access the database. Configuring RAID 1, installing a hybrid drive, upgrading to a 1GB NIC, and upgrading the power supply will not directly improve the laptop's performance when working with a large database. References: CompTIA A+ Certification Exam: Core 1 - Objective 3.1

QUESTION NO: 4

A technician is upgrading a legacy wireless router for a home user. After installing the new router and configuring the SSID to be the same, none of the devices will connect to the network. Which of the following should the technician check NEXT?

- A. DHCP pool configuration
- B. MAC filtering list
- C. Wireless protocol settings
- D. DNS servers

ANSWER: B

QUESTION NO: 5

A user connects a smartphone to a laptop. Which of the following types of networks has the user created?

- A. PAN
- B. MAN
- C. WLAN
- D. LAN

ANSWER: A

QUESTION NO: 6

The owner of a restaurant reports that wireless network connections are lost intermittently throughout the day. Which of the following steps should a technician take to troubleshoot the issue? (Select TWO).

- A. Identify the location of devices that utilize 2.4GHz.
- B. Check to see if the phones are IJTP or STP lines.
- C. Test to see if the copper electrical Wires are causing interference.
- D. Map all of the wireless signals in the restaurant.
- E. Verify T568B is being used in the wiring closet patch panel.
- F. Schedule timed router reboots throughout the day.

ANSWER: A D**Explanation:**

The correct answers are A. Identify the location of devices that utilize 2.4GHz and D. Map all of the wireless signals in the restaurant. In order to troubleshoot the issue, the technician should first identify the location of devices that utilize the 2.4GHz frequency, as this can cause interference with the wireless signal. Additionally, the technician should map all of the wireless signals in the restaurant in order to identify any potential sources of interference. Checking to see if the phones are IJTP or STP lines, testing to see if the copper electrical wires are causing interference, verifying T568B is being used in the wiring closet patch panel, and scheduling timed router reboots throughout the day are not necessary steps for troubleshooting this issue.

QUESTION NO: 7

A client wants to connect an external keyboard to an Android tablet. Which of the following connection types are appropriate for this task? (Select TWO).

- A. DVI
- B. Infrared
- C. Lightning
- D. USB-C
- E. PS/2
- F. Bluetooth

ANSWER: D F**Explanation:**

[The appropriate connection types for connecting an external keyboard to an Android tablet are USB-C and Bluetooth.](#)

QUESTION NO: 8

An organization is looking to upgrade the processing ability for its computers. Most users report that whenever multiple applications are being utilized, the system's response time slows down drastically. When only one application is open, the response time is acceptable. Which of the following should be upgraded FIRST?

- A. SSD
- B. CPU
- C. HDD
- D. RAM

ANSWER: D**Explanation:**

The component that should be upgraded first is the RAM. When multiple applications are being utilized, the system's response time slows down drastically. This is because the computer is running out of memory. [Upgrading the RAM will allow the computer to store more data in memory, which will improve performance when multiple applications are being used](#)¹²³.

QUESTION NO: 9

A technician is receiving reports that the entire office sporadically loses network connectivity throughout the day. The technician determines the root cause to be EMI. Which of the following cable mediums would be the MOST cost effective without sacrificing system performance?

- A. Coaxial
- B. Shielded Cat 6
- C. Plenum Cat 5e
- D. Multimode fiber

ANSWER: B**Explanation:**

In this situation, the MOST cost-effective cable medium that would not sacrifice system performance would be B. Shielded Cat 6. Electromagnetic interference (EMI) can disrupt network connectivity by interfering with the signals transmitted over network cables. Shielded Cat 6 cables are designed to provide protection against EMI by incorporating a layer of shielding material around the cable's conductors. This shielding helps to prevent EMI from interfering with the signals transmitted over the cable.

QUESTION NO: 10

A user reports a cell phone is getting hot. Which of the following are MOST likely to be possible causes? (Select THREE).

- A. Using the device as a Wi-Fi hotspot

- B. A cracked screen
- C. A failing battery
- D. Less than 15% free storage space on the phone
- E. Privileged control
- F. Recurring prompts to install OS updates
- G. Granting too many application camera permissions
- H. Too many open applications

ANSWER: A C H

QUESTION NO: 11 - (HOTSPOT)

A customer built a computer for gaming, sourcing individual components and then assembling the system. The OS starts up, but within a few minutes the machine locks up. The customer brought the computer to a technician to diagnose the issue.

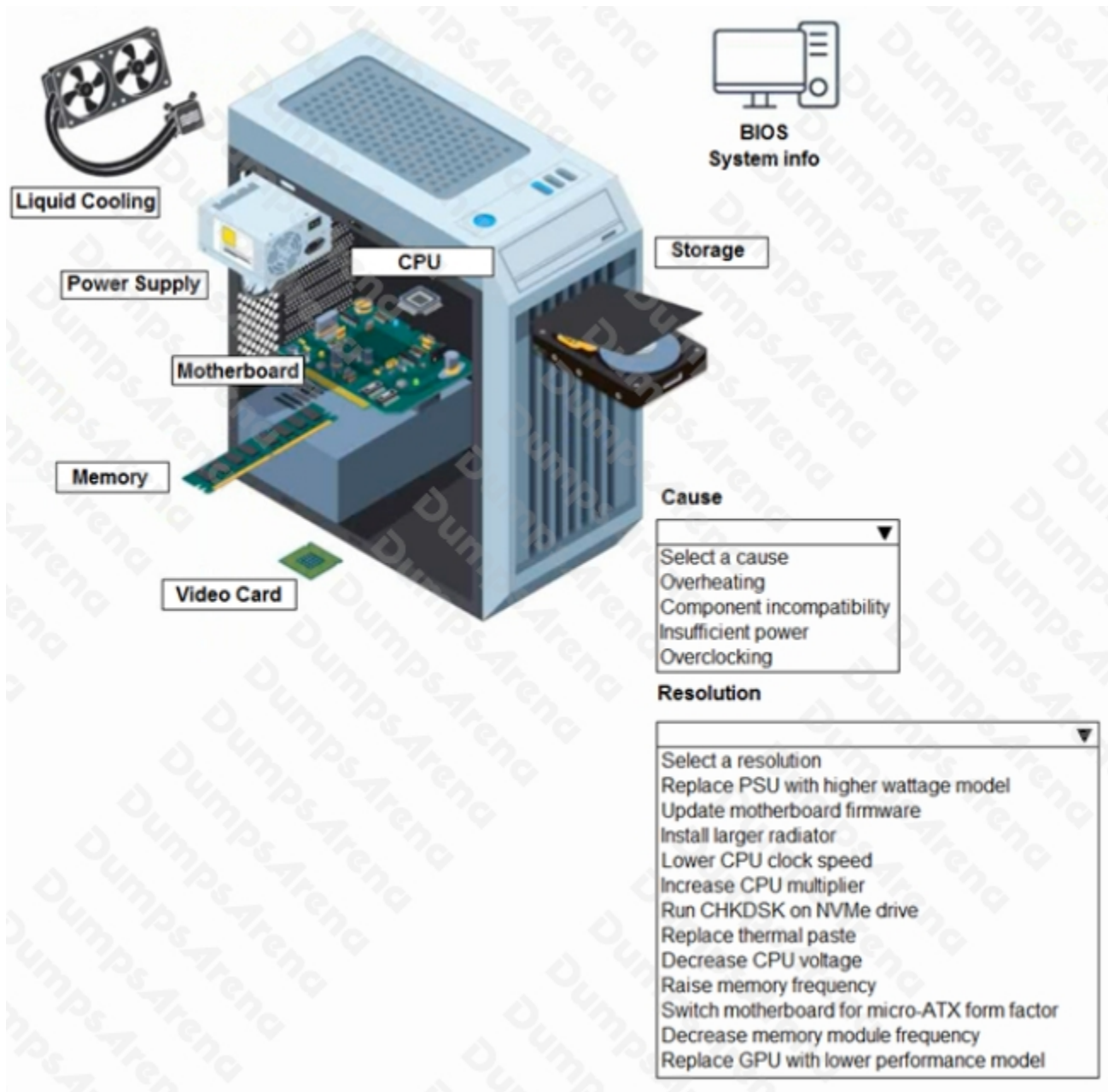

ANSWER:

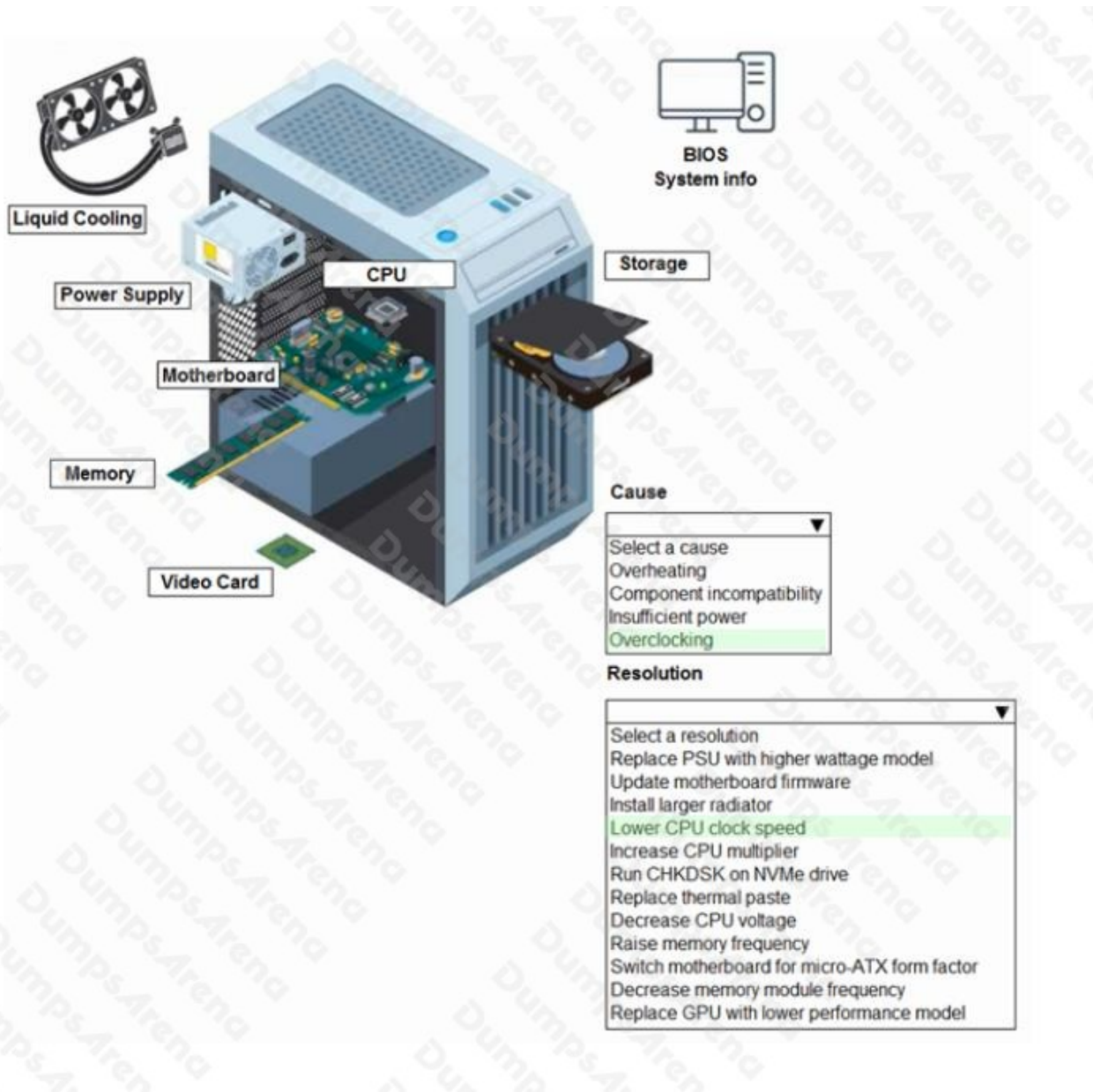

Explanation:

correct answer is "Overclocking" and "Reduce CPU Clock speed" CPU is at 4.5 Ghz when normal is 3.2 Ghz. Overclocking too much can cause freezes, and this is a gaming computer so the user probably took it too far.
<http://blog.logicalincrements.com/2018/12/4-troubleshooting-tips-overclocking-pc/>

QUESTION NO: 12

Which of the following are default ports for HTTP and HTTPS traffic? (Select TWO).

- A. 23
- B. 25

- C. 80
- D. 143
- E. 389
- F. 443

ANSWER: C F

QUESTION NO: 13

A technician needs to add storage to a workstation. The workstation does not have room to add any internal storage, so the technician plans to add an external storage device. Which of the following connection types should the technician MOST likely use?

- A. SCSI
- B. eSATA
- C. PCIe
- D. NVMe

ANSWER: B

Explanation:

eSATA is the best choice for adding external storage as it offers a fast transfer rate and is specifically designed for external storage devices. SCSI is an older interface that is rarely used today, PCIe is typically used to add expansion cards to a computer, and NVMe is a newer interface for high-speed solid-state storage, but it is typically used for internal storage devices.

QUESTION NO: 14

Which of the following options provides correct information about 2.4GHz and 5GHz wireless frequencies? (Select TWO)

- A. 2.4GHz has less interference. 5GHz transmits in lower speed.
- B. 2.4GHz penetrates solid objects more effectively. 5GHz provides faster data connections.
- C. 2.4GHz has a higher data rate. 5GHz has 23 channels.
- D. 2.4GHz has 11 channels. 5GHz has no data interference.
- E. 2.4GHz has a higher coverage area. 5GHz has higher bandwidth.
- F. 2.4GHz has a higher bandwidth. 5GHz has lower transmit power.

ANSWER: B E

Explanation:

The correct answers are B. 2.4GHz penetrates solid objects more effectively. 5GHz provides faster data connections and E. 2.4GHz has a higher coverage area. 5GHz has higher bandwidth. The 2.4GHz frequency has a lower data rate compared to 5GHz, but it can penetrate solid objects more effectively and has a higher coverage area. The 5GHz frequency, on the other hand, provides faster data connections and has higher bandwidth, but it has fewer channels and lower transmit power.

QUESTION NO: 15

A user on a SOHO network is unable to watch online videos, even at 240 pixels. The technician runs ipconfig from the user's computer and records the following:

```
Connection-specific DNS Suffix . : lan
Link-local IPv6 Address . . . . . : fe80::1585:7fb2:b05f:7102%12
IPv4 Address. . . . . : 192.168.1.131
Subnet Mask . . . . . : 255.255.255.0
Default Gateway . . . . . : 192.168.1.1
```

The technician then connects a test laptop to the router via the user's Cat 5 cable and records the following information:

```
Download: 85 mbps
Upload: 22 mbps
Ping: 28 ms
```

Which of the following is MOST likely causing the user's issue?

- A. Incorrect IP address
- B. Faulty NIC
- C. Misconfigured default gateway
- D. Bad network cable

ANSWER: B**Explanation:**

Based on the information recorded by the technician, the network connection appears to be functioning normally. The user's computer is properly configured with an IPv4 address, subnet mask, and default gateway, which should allow the user to access the internet and online videos. The high download and upload speeds and low ping time recorded from the test laptop also indicate that the network is working well. However, the user's inability to watch online videos suggests that there might be an issue with the network card (NIC) on the user's computer. The NIC might be faulty or malfunctioning, which is preventing the computer from receiving and processing the video data. The technician should try replacing the NIC to resolve the issue.